

# EXHIBIT "B" Site Plan

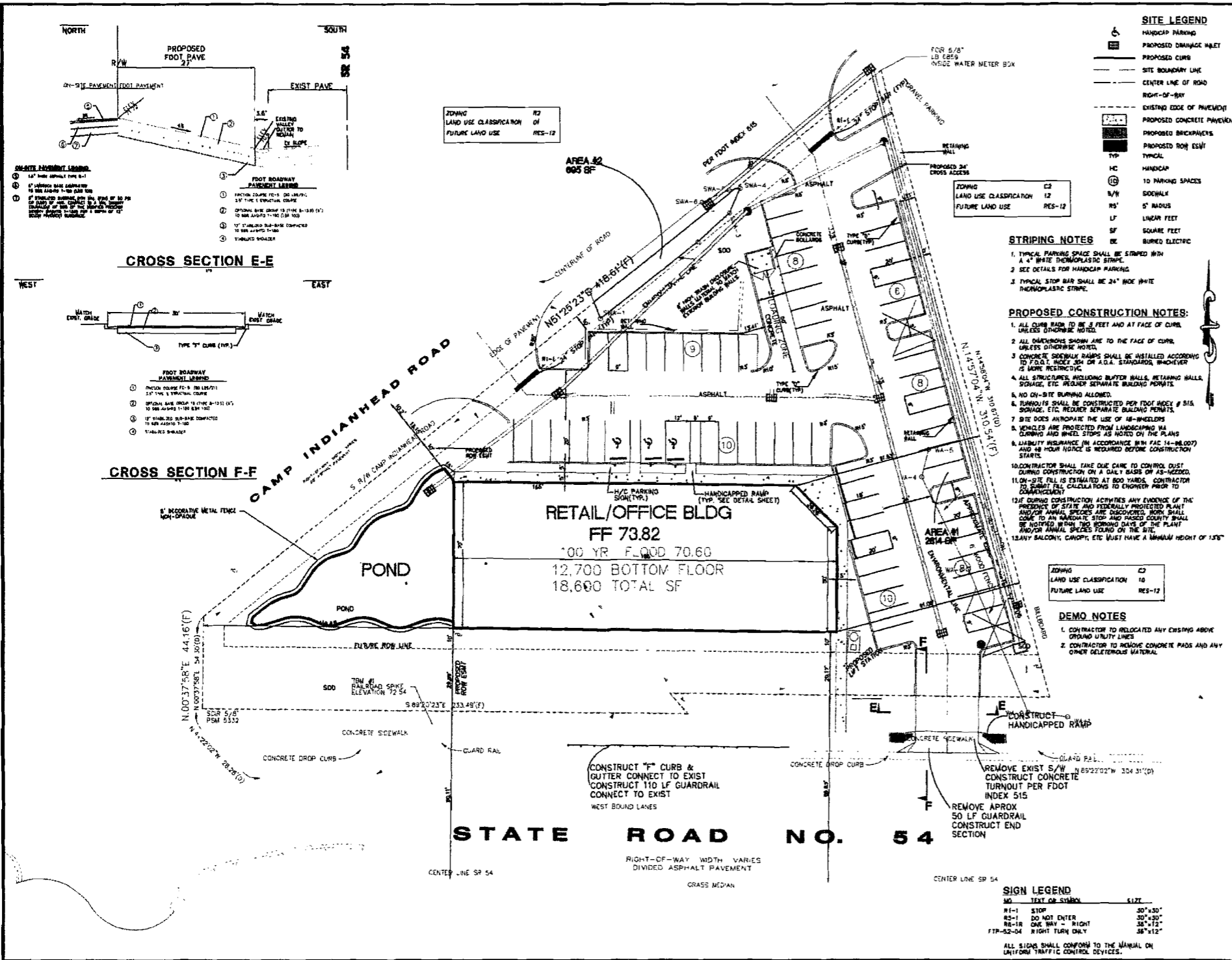

### SITE LEGEND

- HANDICAP PARKING
- PROPOSED DAMAGE INLET
- PROPOSED CURB
- SITE BOUNDARY LINE
- CENTER LINE OF ROAD
- RIGHT-OF-WAY
- EXISTING EDGE OF PAVEMENT
- PROPOSED CONCRETE PAVEMENT
- PROPOSED BRICKPAVEMENT
- PROPOSED ROAD EDGE
- TYPICAL
- HANDICAP
- 10 PARKING SPACES
- SIDEWALK
- 5' RADIUS
- LF
- SF
- BURIED ELECTRIC

### STRIPING NOTES

1. TYPICAL PARKING SPACE SHALL BE STRIPED WITH A 4" WHITE THERMOPLASTIC STRIPE.
2. SEE DETAILS FOR HANDICAP PARKING.
3. TYPICAL STOP BAR SHALL BE 24" WIDE WHITE THERMOPLASTIC STRIPE.

### PROPOSED CONSTRUCTION NOTES:

1. ALL CURB RAIN TO BE 3 FEET AND AT FACE OF CURB UNLESS OTHERWISE NOTED.
2. ALL DIMENSIONS SHOWN ARE TO THE FACE OF CURB UNLESS OTHERWISE NOTED.
3. CONCRETE SIDEWALK RAMPS SHALL BE INSTALLED ACCORDING TO F.D.O.T. INDEX 504 OR A.G.A. STANDARDS, WHICHEVER IS MORE RESTRICTIVE.
4. ALL STRUCTURES, INCLUDING BUFFER WALLS, RETAINING WALLS, SIGNAGE, ETC. REQUIRE SEPARATE BUILDING PERMITS.
5. NO ON-SITE BURNING ALLOWED.
6. TURNOUTS SHALL BE CONSTRUCTED PER FOOT INDEX # 515 SIGNAGE, ETC. REQUIRE SEPARATE BUILDING PERMITS.
7. SITE DOES NOT REQUIRE THE USE OF 48-INCH WHEELERS.
8. VEHICLES ARE PROTECTED FROM LANDSCAPING VIA CURBING AND WHEEL STOPS AS NOTED ON THE PLANS.
9. LIABILITY INSURANCE (IN ACCORDANCE WITH FAC 14-186.007) AND 48 HOUR NOTICE IS REQUIRED BEFORE CONSTRUCTION STARTS.
10. CONTRACTOR SHALL TAKE DUE CARE TO CONTROL DUST DURING CONSTRUCTION ON A DAILY BASIS OR AS-NEEDED.
11. ON-SITE FILL IS ESTIMATED AT 800 YARDS. CONTRACTOR TO SUBMIT FILL CALCULATIONS TO ENGINEER PRIOR TO CONSTRUCTION.
12. IF DURING CONSTRUCTION ACQUIRES ANY EVIDENCE OF THE PRESENCE OF STATE AND FEDERALLY PROTECTED PLANT AND/OR ANIMAL SPECIES ARE DISCOVERED, WORK SHALL COME TO AN IMMEDIATE STOP AND HARRIS COUNTY SHALL BE NOTIFIED WITHIN TWO WORKING DAYS OF THE PLANT AND/OR ANIMAL SPECIES FOUND ON THE SITE.
13. ANY BALCONY, CANOPY, ETC MUST HAVE A MINIMUM HEIGHT OF 13.5'

ZONING  
LAND USE CLASSIFICATION  
C2  
FUTURE LAND USE  
RES-12

### DEMO NOTES

1. CONTRACTOR TO RELOCATE ANY EXISTING ABOVE GROUND UTILITY LINES.
2. CONTRACTOR TO REMOVE CONCRETE PADS AND ANY OTHER DELETERIOUS MATERIAL.

### SIGN LEGEND

NO.	TEXT OR SYMBOL	SIZE
R1-1	STOP	30" x 30"
R2-1	DO NOT ENTER	30" x 30"
R6-R	ONE WAY - RIGHT	36" x 12"
T1P-52-04	RIGHT TURN ONLY	36" x 12"

ALL SIGNS SHALL CONFORM TO THE MANUAL ON UNIFORM TRAFFIC CONTROL DEVICES.